



# BOARD OF TRUSTEES UPDATE

## ERIC L. BARKER, DEAN

FEBRUARY 8, 2019

**PURDUE**  
UNIVERSITY.

College of Pharmacy

**150** YEARS  
OF  
**GIANTLEAPS**

# Preparing the Next Generation of Leaders in Pharmacy and the Pharmaceutical Sciences

- 600 PharmD students
- Innovative 2-year PrePharmacy Program
- Largest & Oldest PhD Program in Pharmaceutical Sciences
- ~10,000 Continuing Education Certificates Issued Annually for Health Professionals

**TOP TEN**  
Pharmacy Program

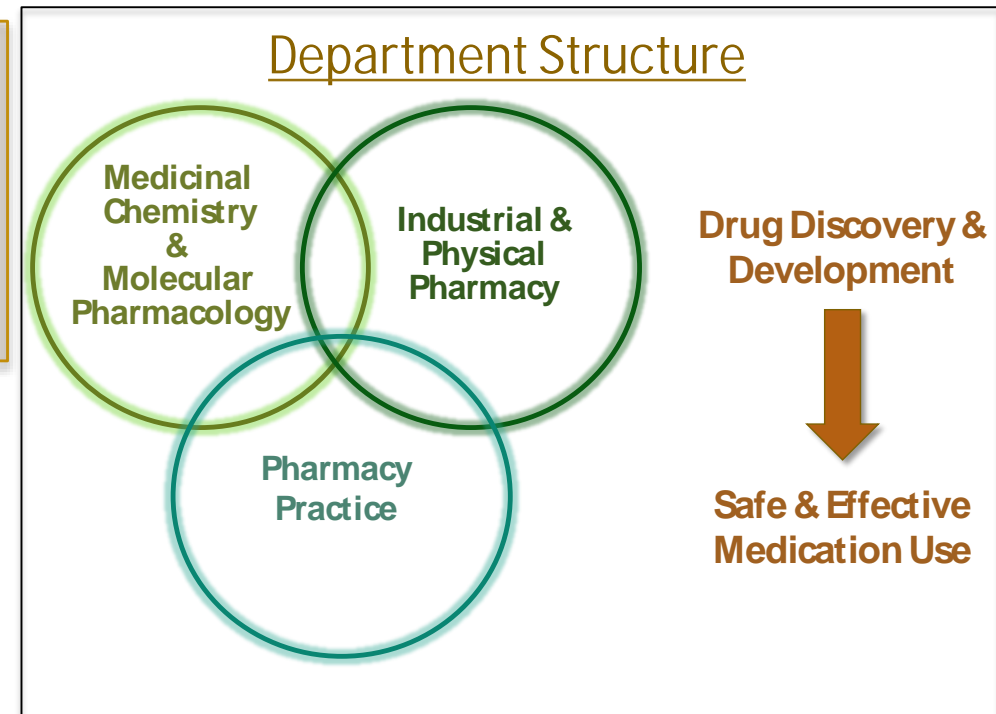

◆  
2/3 of Indiana Pharmacists are Purdue Pharmacy alumni

◆  
FY18 ~\$23M in Sponsored Program Activity

◆  
#1 in Peer Group for Patents Issued & Filed

◆  
20+ Faculty Members (out of 80) have Received Teaching Awards

New Strategic Plan Approved in 2018  
Key Themes: Partnerships, Innovation, Leadership

# Student Experience & Success (Affordability & Accessibility)

# Transformative Education

“Assuring that our students have the knowledge, skills, and the tools to be successful . . . should be considered one of the core responsibilities of the College in preparing our students for future success.”

- Develop innovative educational technologies – using virtual and augmented reality simulations for health professions education.
- Create unique opportunities for leadership development – Leaders & Entrepreneurs Advancing Pharmacy (LEAP) Scholars. Boston Biotech Retreat, Shark Tank Projects.
- Prepare leaders for the Pharma Industry. Online Professional Science Masters in Pharmaceutical Sciences (Drug Development).
- Proactively address student stress and mental health concerns; Wellness Initiatives, Mental Health First Aid

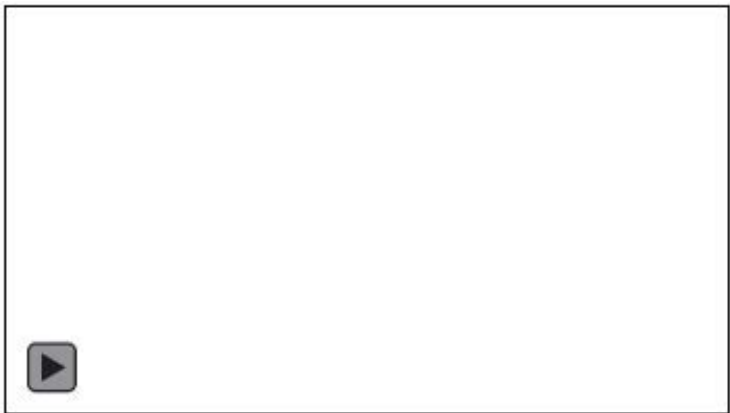

2018 PharmD Class Employment

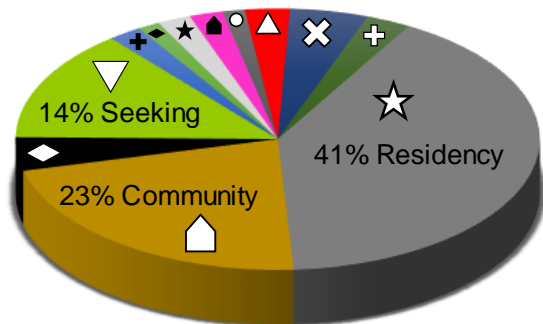

☆ ■ residency (59, 40.69%)	⬆ ■ community-chain (32, 22.69%)
◇ ■ fellowship (6, 4.14%)	▽ ■ still seeking (20, 13.79%) - specific area of U.S.
+ ■ hospital/clinical (3, 2.07%)	◆ ■ undecided - has had offers (2, 1.38%)
★ ■ other - not indicated (3, 2.07%)	▲ ■ industry (3, 2.07%)
○ ■ nuclear (2, 1.38%)	△ ■ post grad intern (4, 2.76%)
⊗ ■ declined to respond (7, 4.83%)	⊕ ■ community-independent (4, 2.76%)

**#1** Students Matching in ASHP Residency Match In Big Ten (59 students)

**#2** Lowest Self-Reported Debt In Big Ten (incl. pre-pharm) \$125,376

**\$113,337**  
Average Starting Salary



College of Pharmacy



# Research & Innovation (World-changing Research)

“... catalyze translational research, foster innovation, and enrich the environment of the College of Pharmacy.”

LyoHub



Purdue research hub to transform freeze-drying process used to make lifesaving drugs, preserve food

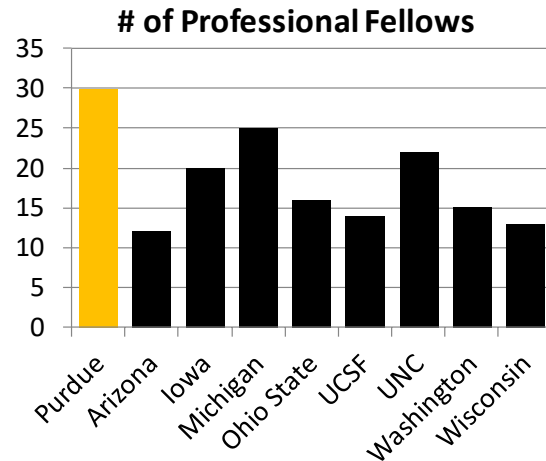
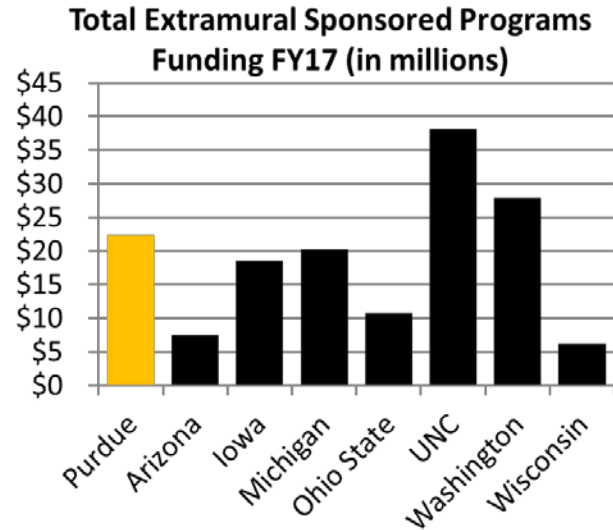

January 4, 2019

**Purdue professor elected a fellow of National Academy of Inventors**



August 28, 2017

**Purdue Institute for Drug Discovery announces new director**



January 22, 2019

**Rochet named director of Discovery Park's Institute for Integrative Neuroscience**

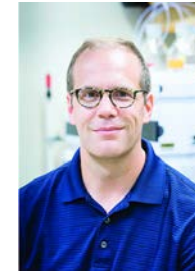

**PURDUE**  
UNIVERSITY

College of Pharmacy

**150** YEARS OF  
**GIANTLEAPS**

**# BOLDER  
HIGHER  
TOGETHER**

- Develop and expand our expertise in the field of precision medicine, with the ultimate goal of becoming a leader in this field – Pharmacogenomics, Predictive Analytics (Data Science)
- Invest in pharmaceutical biotechnology, both in teaching and in research.

# Innovations in Pharmacy Practice

“Pharmacists, as medication experts, are uniquely positioned among health care professionals to positively affect those patient outcomes and to demonstrate the strongest value and quality of the healthcare dollar.”

- Practice is shifting rapidly away from “distributors of product” to “deliverers of patient care.”
  - Create a **Center for Practice Excellence** that will accomplish the following:
    - Develop collaborative partnerships with external employers, professional organizations, and healthcare facilities to increase accessibility and develop novel practice and practice-based research and student experience opportunities.
    - Develop collaborative partnerships with Purdue Human Resources to explore cost-savings and value-based programs for beneficiaries and ensure employees have access to pharmacist services.
  - Address the Opioid Crisis through multi-disciplinary partnerships. BoilerWoRx allows faculty and students to engage in communities with Purdue Extension for naloxone training, policy advocacy, public education, and safe disposal of unused medications.

Purdue Student  
Pharmacists

**Saved**

**\$2,032,066**

Healthcare Dollars

**In 2018**



College of Pharmacy



# Alumni Engagement

“The College aspires to build upon a culture that fosters strong emotional ties and relationships with its alumni in the areas of philanthropy, advocacy, and volunteerism.”

### Pharmacy Giving History

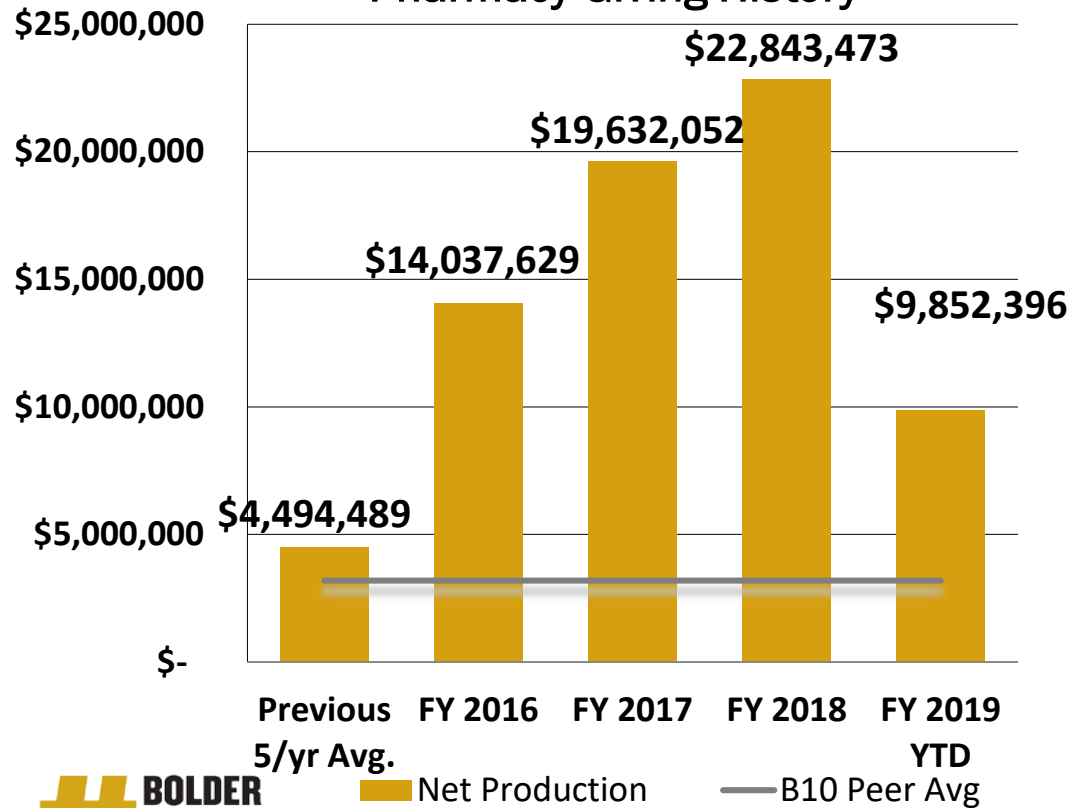

Campaign total

\$77,349,456

**Goal**

\$37,500,000

206% OVER Goal

# 25%

Living Alumni Supported the University Financially in FY18 (#1 on campus)

- Distinguished group of alumni who are leaders in various aspects of pharmacy (e.g., corporate presidents, vice-presidents, entrepreneurs, government, national professional and scientific organizations, academic leaders)
- Key practice: Tailor engagement efforts to recognize alumni lifecycle to increase participation



College of Pharmacy



# Challenges & Opportunities

- Applications to Colleges of Pharmacy are declining nationally. Purdue applications for the PharmD program declined 3.5% this year (Nationally, applications declined 19.0% to date). New recruitments strategies and leadership are planned.
- **Good news:** We have met enrollment target of 150 qualified PharmD students EVERY year.

## Facilities Master Planning with ASG (in collaboration with HHS)

- *“Modernization of space will result In greater flexibility and efficiency”*  
*“Quality is a significant issue”*
- Promoting interprofessional and multidisciplinary collaboration and **partnerships** on campus with units like Nursing and the Life Sciences Institutes by strategically placing this facility near the concentration of life-sciences on south campus.
- **Attracting** the best faculty and students. *Nearly all of our Big Ten peers have better facilities than Purdue, placing us at a competitive disadvantage for faculty and student recruitment.*
- Enhancing **collaboration** within the college by bringing our faculty and students in proximity to each other. Currently fragmented across 8 buildings on and off campus.
- Catalyzing a profound **upward trajectory** of ranking for our PharmD program in keeping with our Big Ten peers.

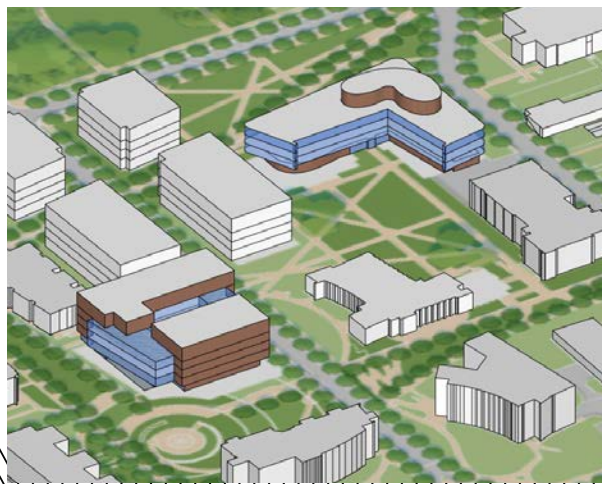

### Future4Pharmacy Initiative

Cash or Cash Pledges	\$4.4M
Planned Gift (Irrev)	\$9.6M
Planned Gift (Rev)	\$10.0M
<b>Total Raised YTD</b>	<b>\$24.0M</b>

**PURDUE**  
UNIVERSITY

College of Pharmacy

**150** YEARS OF  
**GIANTLEAPS**

# Opportunity: Partnership with Purdue Global Pharmacy Technician Education & Training

“There are several compelling reasons for the Purdue University College of Pharmacy to become more involved in pharmacy technician education and training. These reasons include, but are not limited to:

- providing a healthy professional environment for pharmacists to care for patients (*advancement of the profession of pharmacy*)
- to address workforce development issues among the broader community through provision of a well-trained technician workforce that is career minded (*workforce development*)
- consistency with the overall goals and mission of Purdue (*part of the land-grant mission*)”

## CAREER STAGE

Whether you're early or later in your career, these stackable credentials will help get you where you want to go.

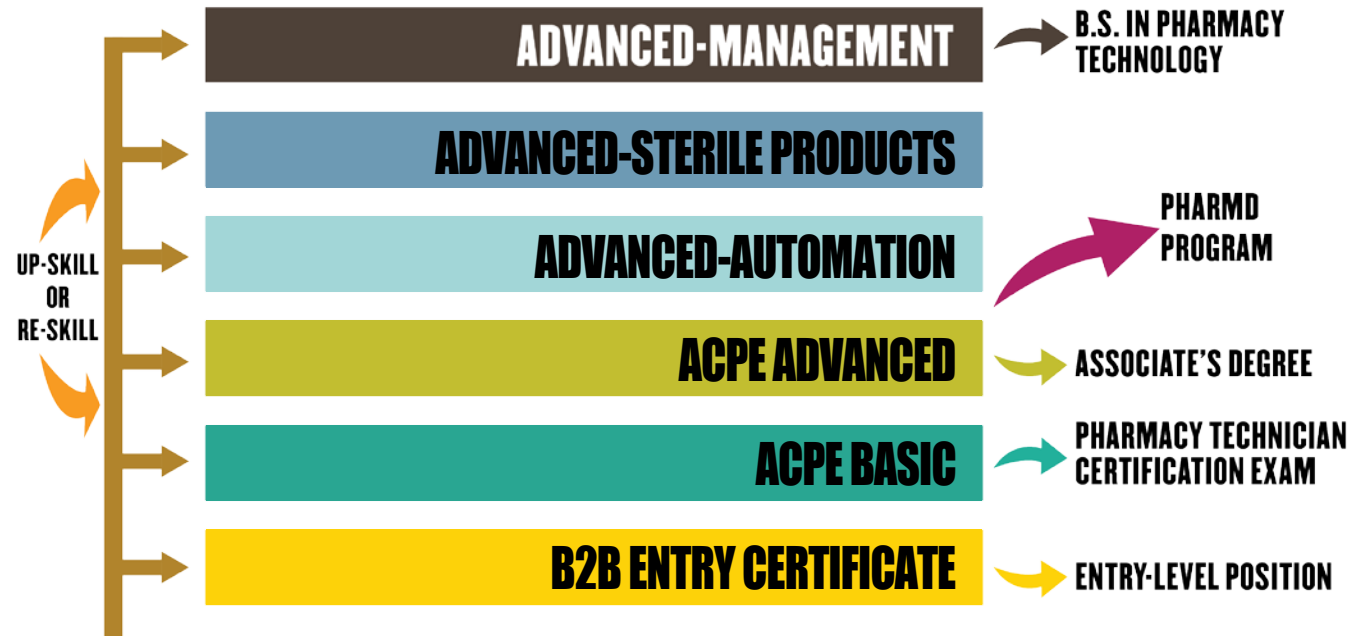

PHARMACY TECHNICIAN  
**STACKABLE  
CREDENTIALS**

**PURDUE**  
UNIVERSITY.  
GLOBAL

**PURDUE**  
UNIVERSITY.  
College of Pharmacy

**150** YEARS OF  
GIANTLEAPS

**# BOLDER  
HIGHER  
TOGETHER**



THANK YOU

**# BOLDER  
HIGHER  
TOGETHER**

**WE ARE PURDUE. WHAT WE MAKE MOVES THE WORLD FORWARD.**

**PURDUE**  
UNIVERSITY.

College of Pharmacy

**150** YEARS  
OF  
**GIANTLEAPS**