

Onshape Introduction Arcs

Left click on the onshape icon at the top left of the ribbon and create a new document.

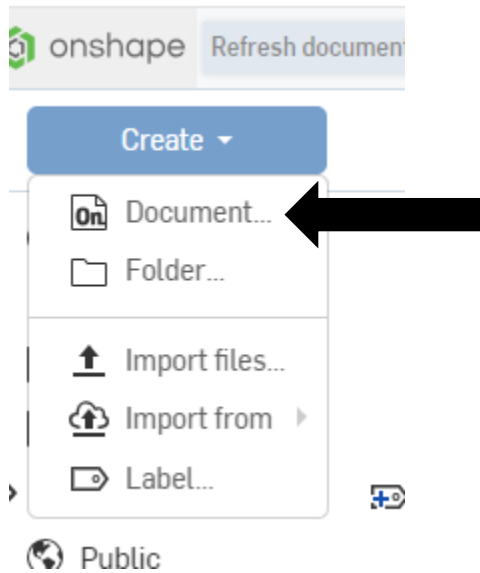

Label the new Sketch Arcs and then left click on Create.

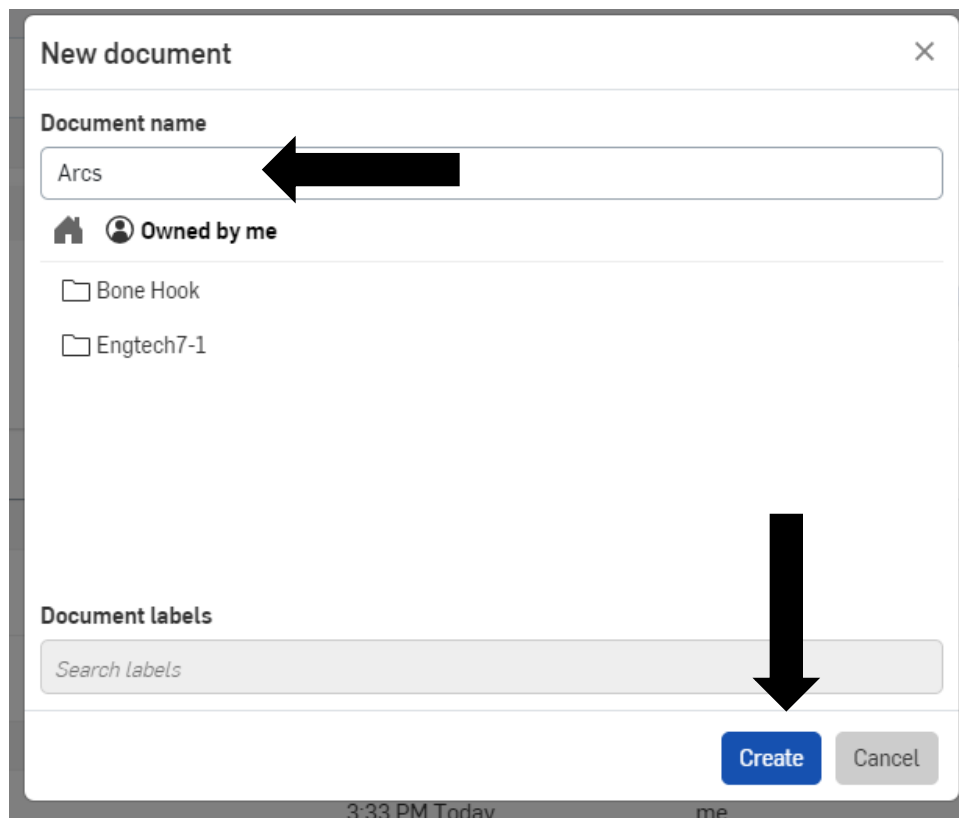

Left click on Sketch then left click on the Front plane and then left click on Front on the view cube. The drawing plane will rotate.

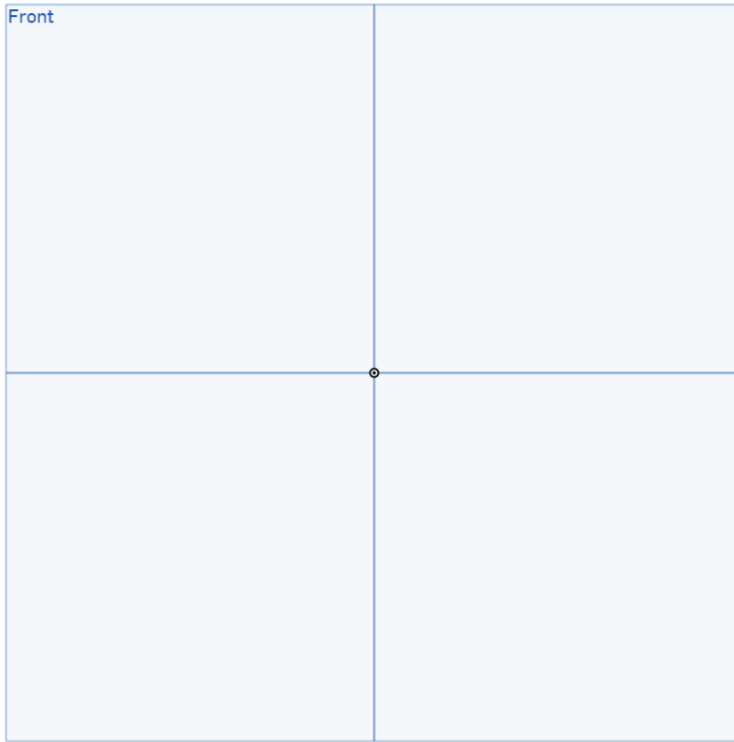

Left click on the Arc drop down arrow. There are five different types of arcs. The basic Arc is the 3 point arc so left click on 3 point arc. The first click is one end point, the second click is the other end point and the third click sets the radius and direction of the arc.

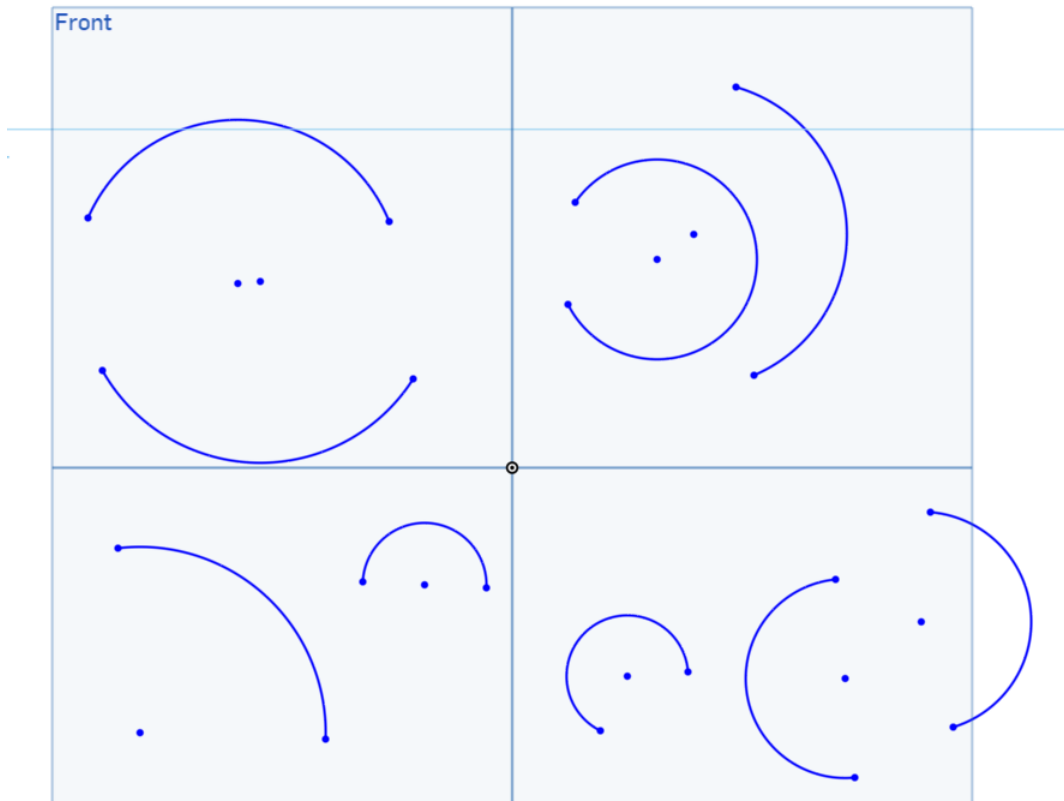

Left click on the Center point arc and pan the drawing area using the middle mouse button to move the 3 point arcs to the left. The first click is the center of the arc, the second click sets the radius and the third click sets the distance of the arc.

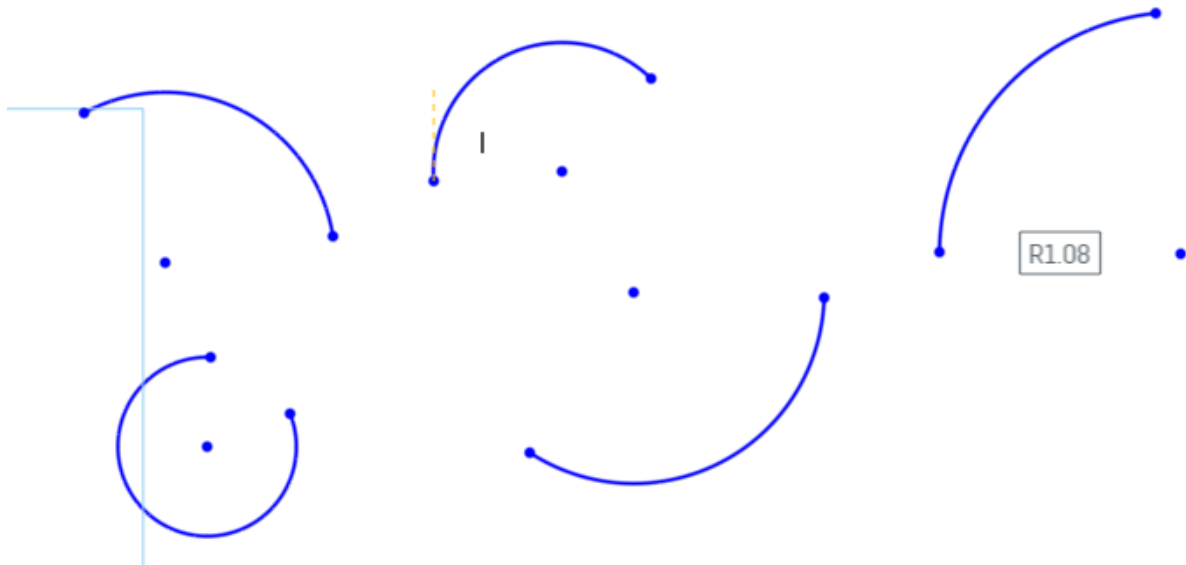

Right click and escape from the arc. Left click on elliptical arc. It will also take four clicks. First click sets the center of the ellipse, second and third click set the distance and shape of the ellipse while the fourth click sets the arc.

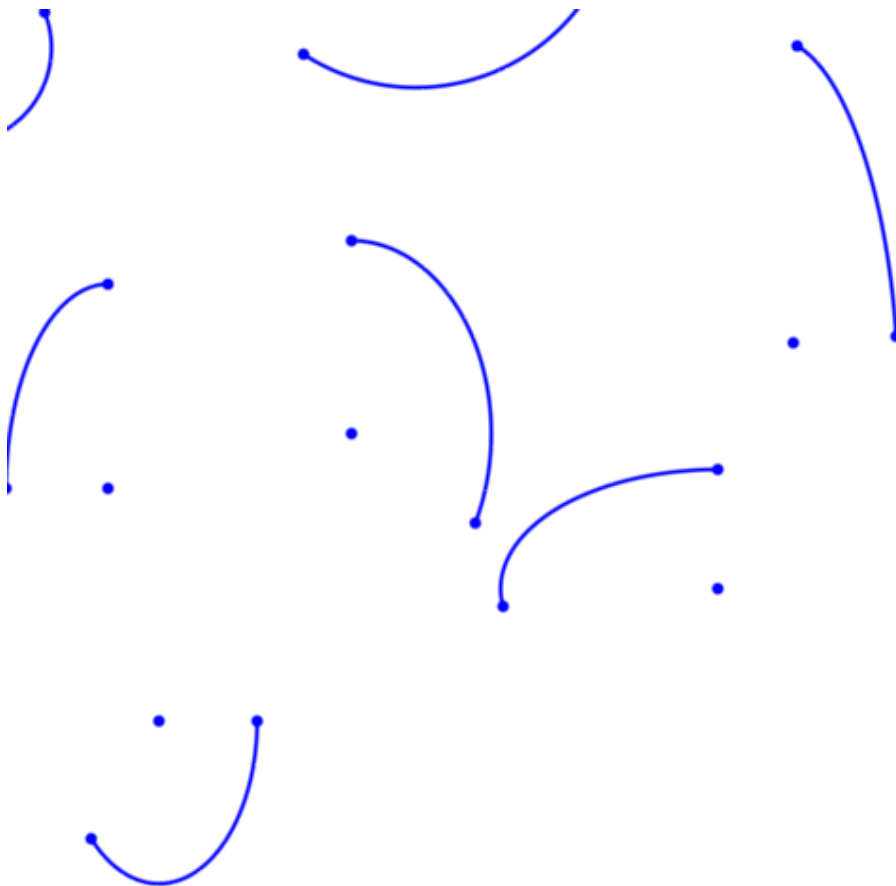

Right click to escape the arc command. Press the middle mouse button to pan the screen up to make more room for more arcs. Select the Conical arc by left clicking the first end point then click for the second end point. The third click will set the distance and direction. The conical arc will not be part of a perfect circle so you can make customized arcs. Try it.

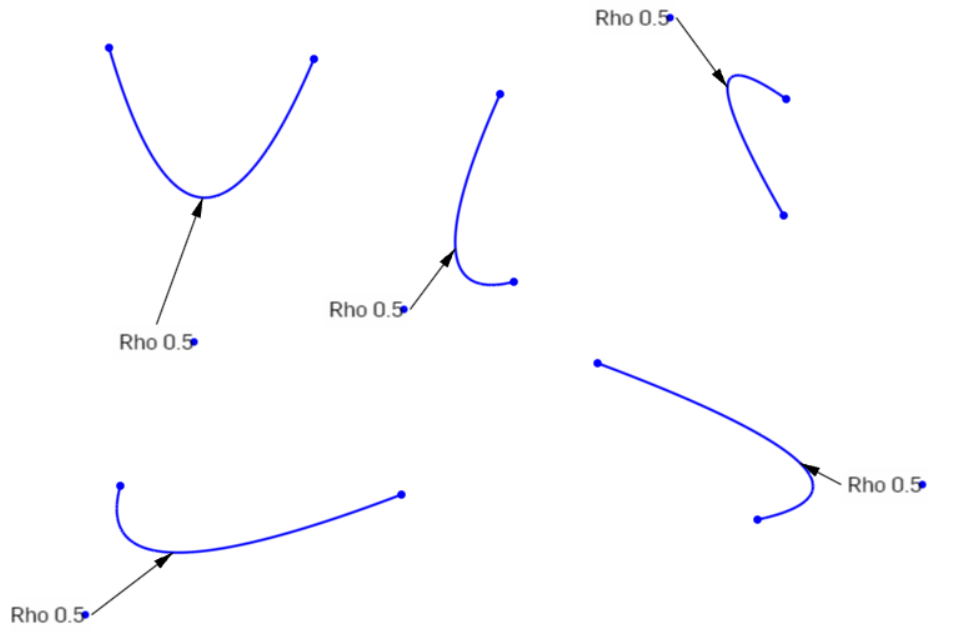

Escape the conical arc left click the drop down arrow and select the tangent arc. You will click on the end point of any of your other arcs and add a new arc tangent to the arc you select. Add a tangent arc to some of the other arcs. Escape the tangent arcs when done.

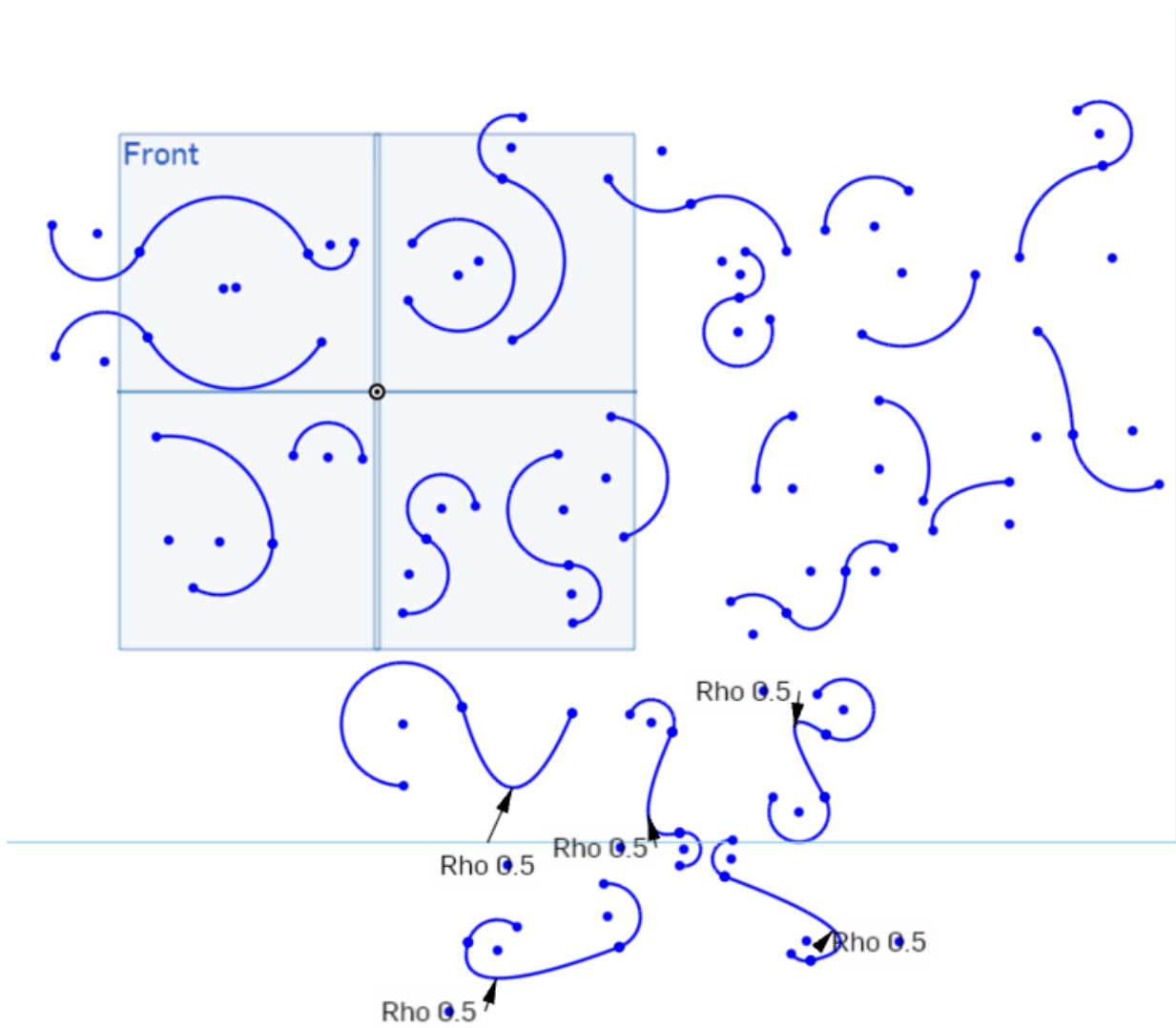

Left click on the green check mark to finish the Arc sketches.

