

Onshape Introduction Polygons

Create a new document and name it Polygons and then click Create on the bottom of the window.

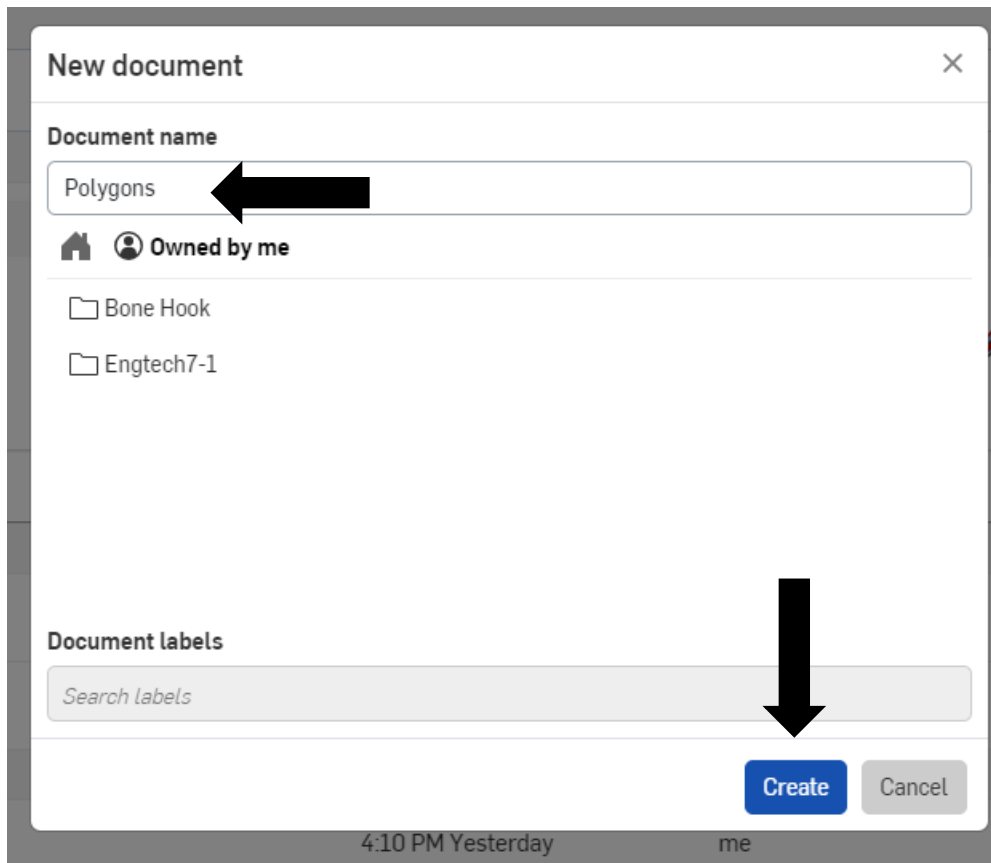

Left click on Sketch then left click on the Front plane and left click Front on the View Cube.

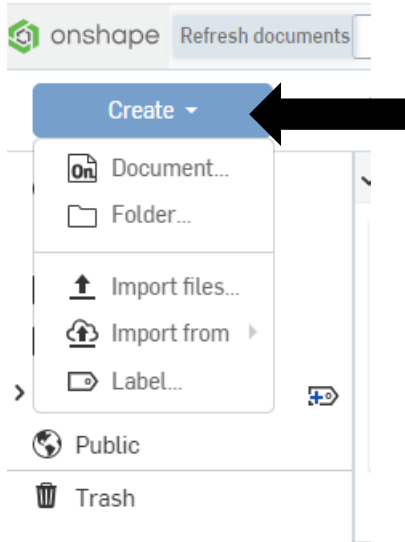
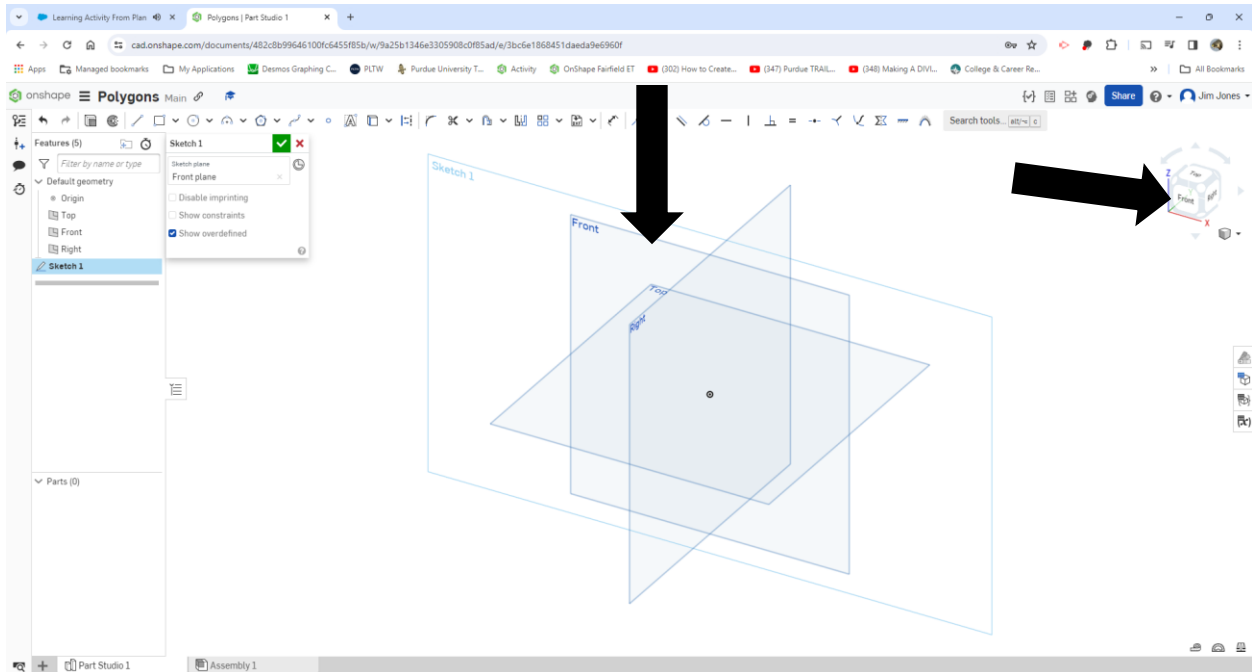

This will rotate the drawing plane. Select the Polygon icon drop down arrow on the ribbon. There are two types of polygons, Inscribed which means the polygon would go around a circle and Circumscribed which means the polygon goes inside a circle.

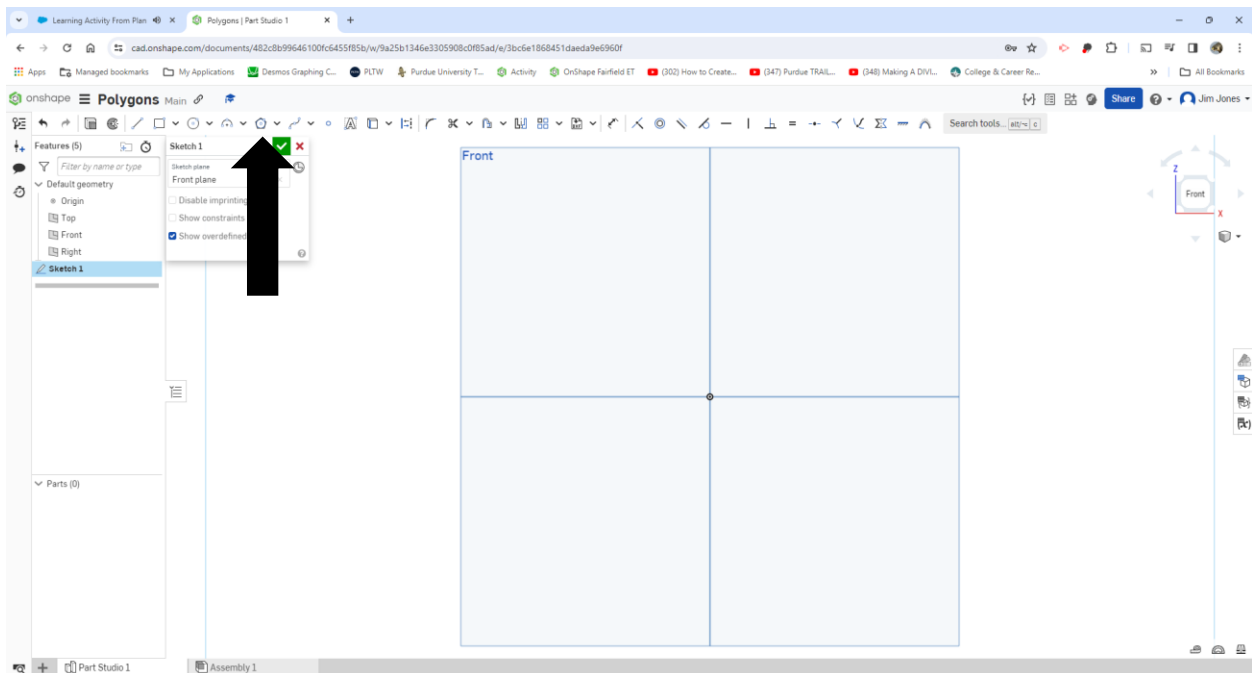

Select the Inscribed method and left click the center of the polygon and the second click set the distance and then you can move the mouse to set the number of sides. Three to 10

sides will work best for practice. More than 10 sides makes the polygon look like a circle. Start with three sides for the first one and then make a new polygon in each quadrant using different number of sides. Right click and Escape the polygon or press the Escape key to stop making polygons.

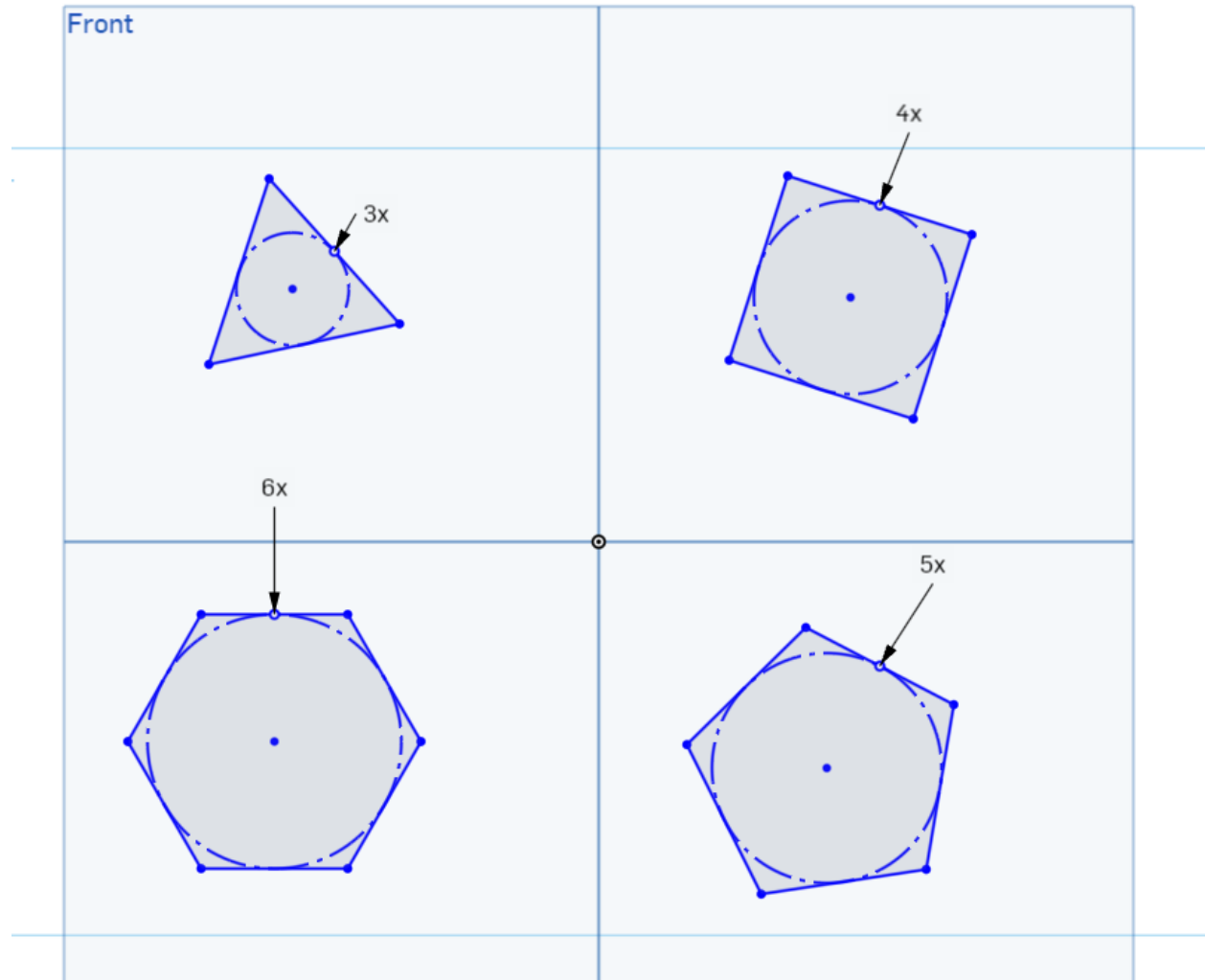

You can left click on any polygon and move it to relocate or resize the polygon.

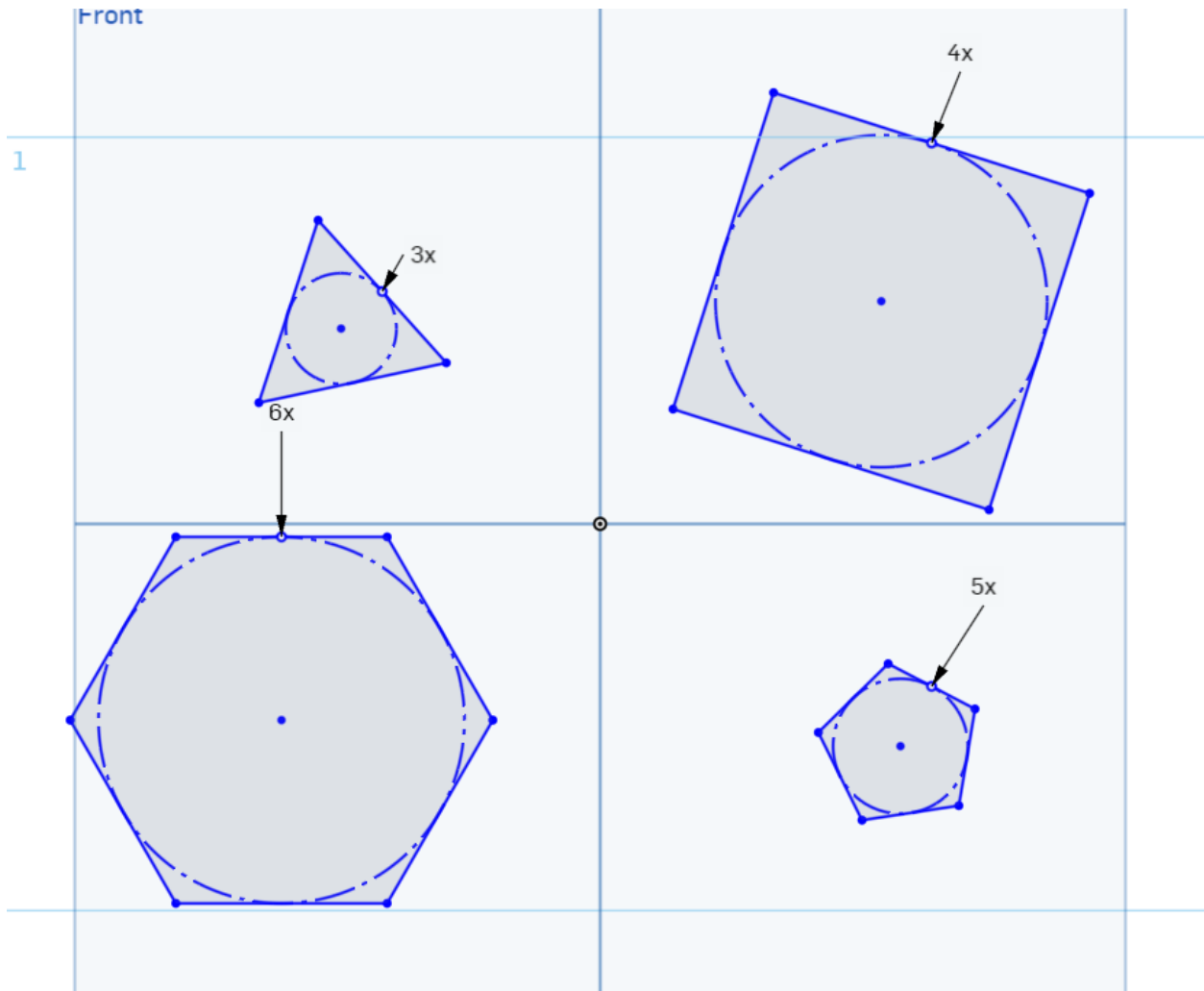

Left click on the green check mark and you can now Extrude the polygons. Click on the Isometric icon near the view cube to see the Extrudes. Extrude each polygon by left clicking on the green check mark to make individual extrudes. Be sure to turn on the Eye after the first extrude to see the sketches reappear.

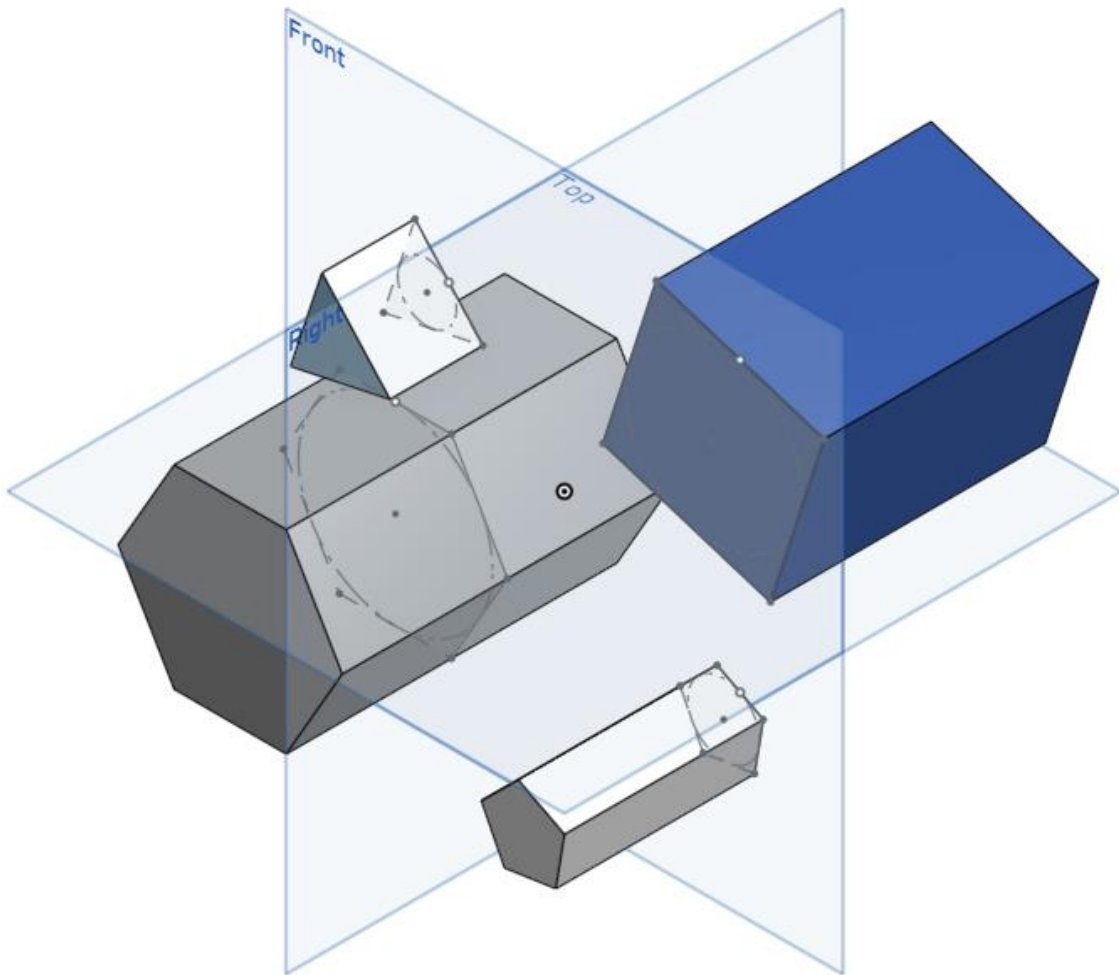

Start a new sketch on the Front plane and select the Circumscribed method and make four more polygons to the right side of the first four. Notice the circle on the outside of the polygon.

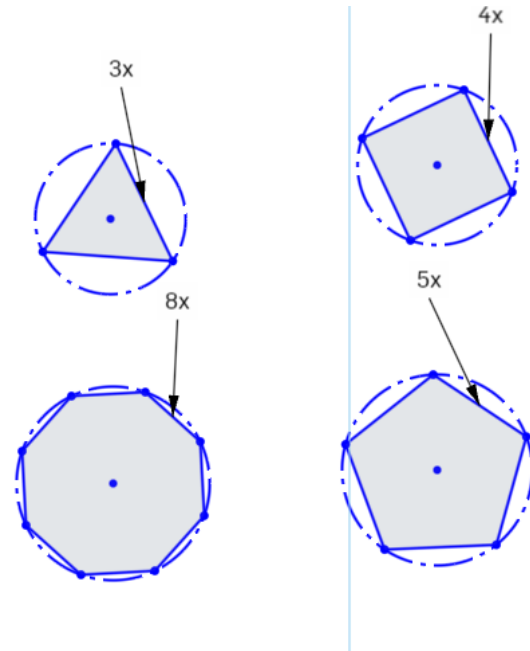
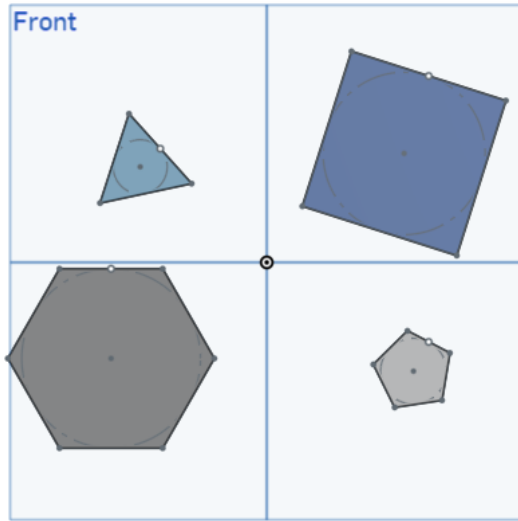

There will be different situations where a specific type of polygon will be needed so it is good to know what works for you. Left click on the green check mark to finish the sketch. You can extrude these shapes or just leave them as sketches. Feel free to make more polygons with new sketches for more practice.

